

Please Read Before Operating!

Your ActiveCare product is packaged with a packet of tools you will need for initial setup. Please locate this packet first.

Quick Start Guide Spitfire Scooters

ActiveCare

Medical

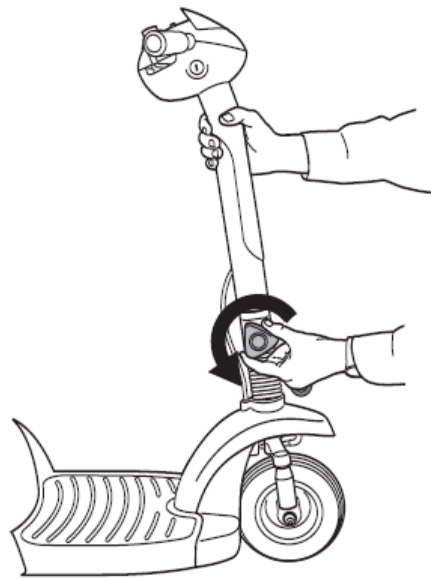

1. Raise the tiller by loosening the adjustment knob pictured, then putting the tiller in the upright position and re-tightening the knob.

2. Remove the battery pack by grasping the handle and pulling upward.

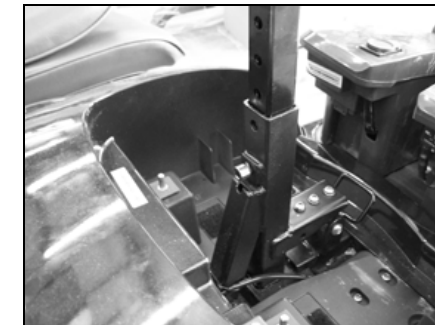
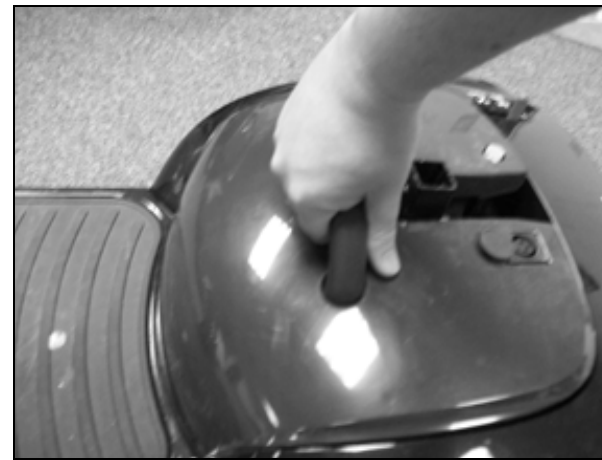

3. Insert the seat post into the scooter's frame.



4. Insert the seat post bolt so that the bolt passes through both the scooter frame and the seat post. Adjust the seat's height by inserting the bolt through the desired holes in the seat post.



5. Tighten the bolt below the seat post bolt with the included Allen wrench

7. Attach the seat by lifting up on the handle on the right side of the seat and placing the seat down on the scooter's seat post. Releasing the handle will lock the seat in place. When the seat is locked, you will hear a click.

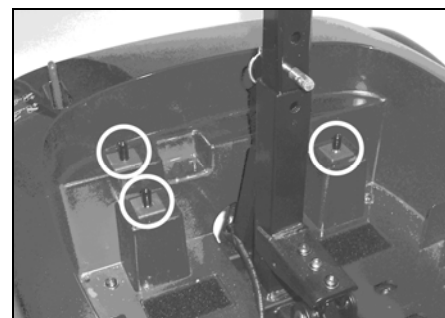
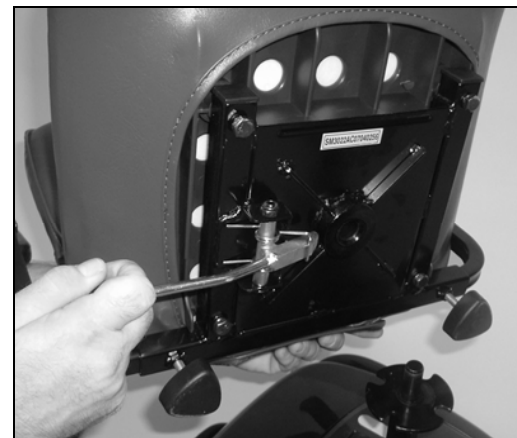

6. Locate the three black rubber caps covering the terminals in the battery compartment area. Remove the three rubber caps. Your scooter **WILL NOT** operate unless these caps are removed.

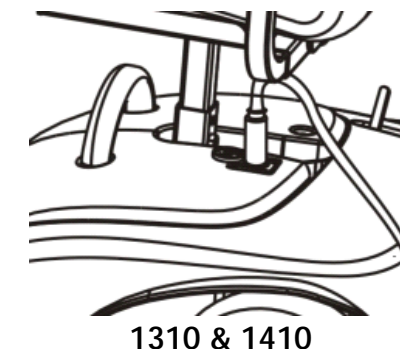

1310 & 1410

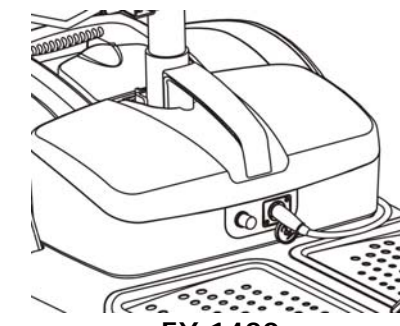

EX 1420

8. Fully charge the scooter's battery by inserting the round charger connector into the battery charging terminal on the scooter's battery pack and inserting the 3-pronged plug into a standard electrical outlet.

Full charging normally takes 6-8 hours, but can take as many as 10 hours depending on the batteries' charge level when starting and the ambient temperature.

Spitfire Quick Start Guide

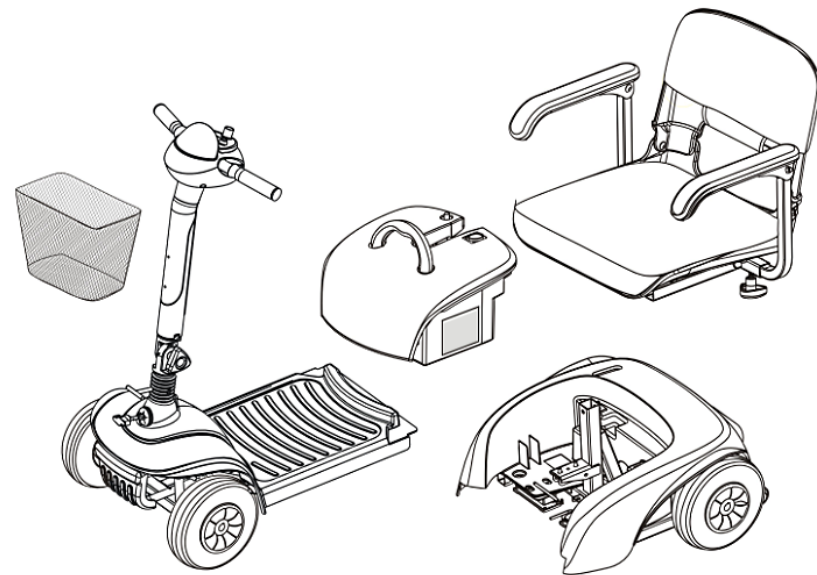

Your Spitfire Scooter is designed to be easily disassembled into 5 pieces for convenient transport or storage.

The pieces are:

- Front Section
- Rear Section (heaviest piece, 28 lbs.)
- Battery Pack
- Seat
- Basket

To disassemble your Spitfire Scooter:

1. Turn key switch to "OFF."
2. Turn tiller adjustment knob to "Lock" position.
3. Place the freewheel mode lever in the "Drive" position.
4. Pull upward on the swivel-release lever to remove the seat from seat post.
5. Pull up on the battery pack to remove it from the scooter.
6. Pull up on the release lever to separate the front and rear sections.

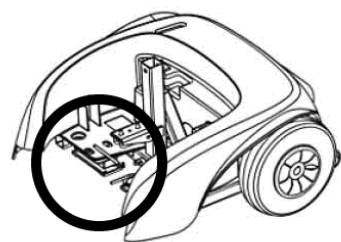

1310 & 1410
Located under battery pack

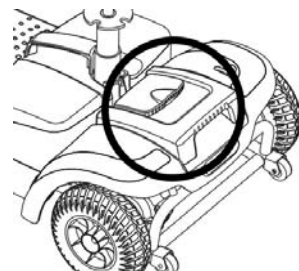

EX 1420
Located behind seat post

READ BEFORE UNPACKING

Apparent Loss or Damage

Upon receipt of this shipment, if any evidence of loss or damage is revealed through visual inspection, then it must be noted on the freight bill and signed by the carrier's agent. Failure to do this may result in the carrier's refusal to honor loss or damage claim. The carrier will furnish you with the necessary forms to file the claim.

Concealed Loss or Damage

When loss or damage is not apparent until the unit is unpacked, a claim for concealed loss or damage is required. When damage is discovered, make a written statement to the carrier for inspection. This request must be made within 15 days of delivery. Keep all cartons and fillers for inspection. Carrier will furnish inspection report and necessary forms to file concealed loss or damage claim, since such damage or loss is the carrier's responsibility.

This Quick Start Guide offers basic information on initial product setup only. Read the owner's manual and all supplemental information thoroughly before operating the product for information on safety, battery charging, basic operation, comfort adjustments, disassembly and care and maintenance.

NOTE: The illustrations provided may not reflect your actual unit.

www.activecaremed.com